

ELECTRIC LAWNMOWER

RAC1030ELA

USER GUIDE

CAUTION: Read the instructions before using the tool.

CONTENTS

| | |
|------------------------------|----|
| 1. SAFETY INSTRUCTIONS | 3 |
| 2. THE PRODUCT | 11 |
| 3. ASSEMBLY | 12 |
| 4. OPERATION | 14 |
| 5. MAINTENANCE | 15 |
| 6. DISPOSAL | 15 |
| 7. DECLARATION OF CONFORMITY | 16 |
| 8. WARRANTY | 17 |
| 9. PRODUCT FAILURE | 18 |
| 10. WARRANTY EXCLUSIONS | 19 |

1. SAFETY INSTRUCTIONS

**IMPORTANT
READ CAREFULLY BEFORE USE.
KEEP FOR FUTURE REFERENCE.**

Safe operating practices for electrically powered lawnmowers

1.1 TRAINING

- a) Read the instructions carefully. Be familiar with the controls and the correct use of the machine.
- b) Never allow children or people unfamiliar with these instructions to use the machine. Local regulations can restrict the age of the operator.
- c) Never operate the machine while people, especially children, or pets are nearby.
- d) Keep in mind that the operator or user is responsible for accidents or hazards occurring to other people or their property.

1.2 PREPARATION

- a) While operating the machine always wear substantial footwear and long trousers. Do not operate the machine when barefoot or wearing open sandals. Avoid wearing clothing that is loose fitting or that has hanging cords or ties.
- b) Thoroughly inspect the area where the machine is to be used and remove all objects which can be thrown by the machine.
- c) Before using, always visually inspect to see that the blade, blade bolt and the blade assembly are not worn

or damaged. Replace worn or damaged components in sets to preserve balance. Replace damaged or unreadable labels.

- d) Before use check the supply and extension cord for signs of damage or aging. If the cord becomes damaged during use, disconnect the cord from the supply immediately. **DO NOT TOUCH THE CORD BEFORE DISCONNECTING THE SUPPLY.** Do not use the machine if the cord is damaged or worn.

1.3 OPERATION

- a) Operate the machine only in daylight or in good artificial light.
- b) Avoid operating the machine in wet grass.
- c) Always be sure of your footing on slopes.
- d) Walk, never run.
- e) Mow across the face of slopes, never up and down.
- f) Exercise extreme caution when changing direction on slopes.
- g) Do not mow excessively steep slopes.
- h) Use extreme caution when reversing or pulling the machine towards you.
- i) Stop the blade(s) if the machine has to be tilted for transportation when crossing surfaces other than grass, and when transporting the machine to and from the area to be used.
- j) Never operate the machine with defective guards or shields, or without safety devices, for example deflectors and/or grass collector, in place.
- k) Switch on the motor carefully according to instructions and with feet well away from the blade(s).

- l) Do not tilt the machine when switching on the motor, except if the machine has to be tilted for starting. In this case, do not tilt it more than absolutely necessary and lift only the part, which is away from the operator.
- m) Do not start the machine when standing in front of the discharge opening.
- n) Do not put hands or feet near or under rotating parts. Keep clear of the discharge opening at all times
- o) Do not transport the machine while the power source is running.
- p) Stop the machine, and remove plug from the socket. Make sure that all moving parts have come to a complete stop.
 - whenever you leave the machine,
 - before clearing blockages or unclogging chute,
 - before checking, cleaning or working on the machine,
 - After striking a foreign object. Inspect the machine for damage and make repairs before restarting and operating the machine;
If the machine starts to vibrate abnormally (check immediately)
 - inspect for damage,
 - replace or repair any damaged parts,
 - Check for and tighten any loose parts.

1.4 MAINTENANCE AND STORAGE

- a) Keep all nuts, bolts and screws tight to be sure the machine is in safe working condition.
- b) Check the grass collector frequently for wear or deterioration.

- c) On machines with multi blade, take care as rotating one blade can cause other blades to rotate
- d) Be careful during adjustment of the machine to prevent entrapment of the fingers between moving blades and fixed parts of the machine.

1.5 ADDITIONAL SAFETY RULES FOR LAWN MOWER

- Read the instructions carefully. Be familiar with the controls and the proper use of the appliance.
- Never allow children to use the appliance.
- Never allow people unfamiliar with these instructions to use the appliance. Local regulations may restrict the age of the operator.
- Never operate the appliance with people, especially children, or pets are nearby.
- The operator or user is responsible for accidents or hazards occurring to other people or their property.
- While operating the appliance, always wear substantial footwear and long trousers. Do not operate the appliance when barefoot or wearing open sandals.
- Thoroughly inspect the area where the appliance is to be used and remove all stones, sticks, wires, bones, and other foreign objects.
- Before using, always visually inspect to see that the rotating parts and cutter assembly are not worn or damaged. Replace worn or damaged parts in sets to preserve balance.
- Operate the appliance only in daylight or in good artificial light. Avoid operating the appliance in wet

grass, where feasible. Always be sure of your footing on slopes. Walk; never run. Always work across the face of slopes, never up and down.

- Exercise extreme caution when reversing or pulling the appliance towards to you.
- Do not operate the appliance on excessively steep slopes.
- Use extreme caution when reversing or pulling appliance towards you.
- Stop the rotating parts if appliance has to be tilted for transportation. Do not operate the cutting means when crossing surfaces other than grass, and when transporting the appliance to and from the working area.
- Never operate the appliance with defective guards or shields, or without safety devices, for example deflectors and/or catchers in place.
- Switch on the motor according to instructions and with feet well away from rotating parts.
- Do not tilt appliance when switching on the motor, expect if the appliance has to be tilted for starting. In this case, do not tilt it more than absolutely necessary and lift only the part, which is away from the operator. Always ensure that both hands are in the operating position before returning the appliance to the ground. Do not put hands or feet near or under rotating parts.
- Never pick up or carry an appliance while the motor is running.
- Pull the plug from the socket:
 - . Whenever you leave the machine.
 - . Before clearing a blockage.

- . After striking a foreign object. Inspect the appliance for damage and make repairs as necessary.
- . If the appliance starts to vibrate abnormally, check immediately.
- When the machine is at work in the thick bushes or runs into obstacles it can't cut down, the blade will be stalled so that the machine temperature and current will increase. When the temperature is too high or the current is too large, the overload protection device installed inside the machine will automatically shut off the power to stop the machine (main purpose is to protect motor and prolong motor life). At this moment, let go of the trigger and disconnect power supply of the machine, let the machine cool in some time (1~2 min) and then restart switch, the machine can rework.
- If the supply cord is damaged, it must be replaced by the manufacturer, its service agent or similarly qualified persons in order to avoid a hazard.
- The power extension supply cables must not be of a quality inferior to type H05RN-F/H05RR-F.H05WF/H05VVH2-F for outdoor use, with a minimum section of 1.5 mm². The extension cord must be attached to a coupler according to the IEC 60320-2-3 standard.
- Use a residual current device of 30mA (RCD).
- Secure the cable to the hook before turning on the equipment.
- An incorrect connection can cause serious injury or death.

- Before connecting the appliance, check that the plugs and extension cords are in good condition. Do not use the appliance if the appliance is damaged or worn.
- Never use the appliance if the guards are defective or without safety devices, for example the grass catcher in place.
- Do not use the tool in bad weather conditions (rain, thunderstorms, storms, etc.).
- The handling / connection of the cables must be dry.
- Always avoid contact between an electrical outlet or cable and a wet area (puddle or wet grass).

1.6 RESIDUAL RISKS

Even if you use this product in compliance with all safety requirements, the potential risks of injury and damage remain. The following hazards may arise in the structure and design of this product.

- There are adverse health consequences resulting from the emission of vibration if the product is used for long periods of time or not properly managed and properly maintained.
- There are risks of injury and property damage due to attachments or broken the sudden impact of hidden objects when using cutting.
- Risk of injury to persons and property caused by flying objects.
- Prolonged use of this product exposes the operator to vibrations and can produce so-called "white finger" disease. To reduce the risk, wear gloves and keep your hands warm. If any of the symptoms of "white finger syndrome" occur, seek immediate medical

attention. Symptoms of "white finger" include numbness, loss of sensitivity, tingling, tingling, and pain, loss of strength, color changes or skin condition. These symptoms usually appear on the fingers, hands or wrists. Risk increases at low temperatures.

1.7 INTENDED USE

This mower is designed for natural grass mowing. Any other use is prohibited.

It is suitable only for private use in a garden or plot. Lawnmowers designed for private plots or gardens are those used for the maintenance of grassy areas and private lawns and should not be used in public areas, parks, sports, agricultural or forest areas.

Symbols



Read operator's manual



Risk of projections. Keep bystanders away



Beware of sharp blades. Blades continue to rotate after the motor is switched off –Remove plug from mains before maintenance or if cord is damaged."



Keep supply flexible cord away from cutting means



Guarantee sound power level



Use eye protection and hearing protection



Do not expose to rain

2. THE PRODUCT

2.1 DESCRIPTION

1. Upper handle
2. Lower handle
3. Switch box
4. Grass catcher
5. Wheels
6. Motor cover

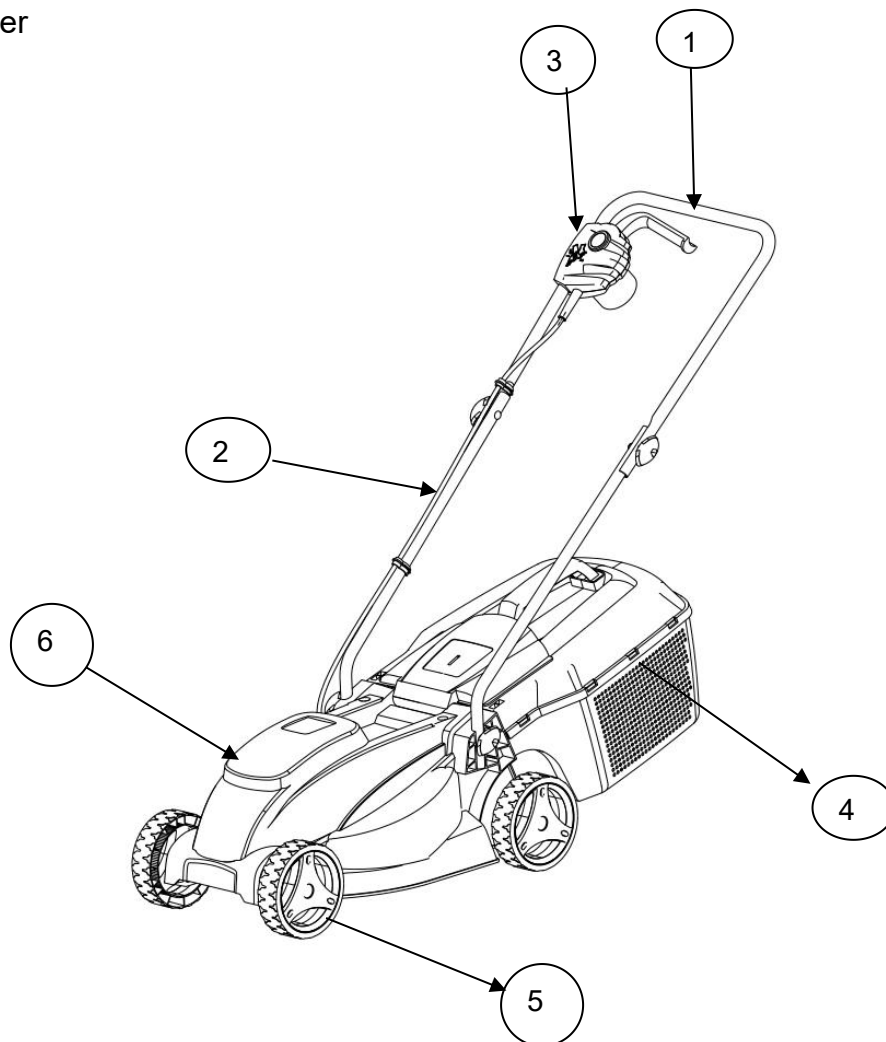

2.2 TECHNICAL DATA

| | |
|-------------------|-----------------------|
| Voltage | 230-240V~ 50Hz |
| Power rating | 1000W |
| No load speed | 3450min ⁻¹ |
| Cutting height | 25/45/65mm |
| Max cutting width | 320mm |

Declared guaranteed sound power level: 96 dB(A)
Measured sound power level: 90,9 dB(A) K= 3,69 dB(A)
Sound pressure level: 78,8 dB(A) K= 3 dB(A)
Vibration: max 1,96 m/s² K= 1,5 m/s²

3. ASSEMBLY

3.1 PREPARATION

- 1) Place the cable hook on the top handle (fig.1a).
- 2) Attach the top and bottom handles with the screws and bolts provided (fig.1b).
- 3) Insert the handles into the body of the mower. (fig.1c). Screw them with the provided screws.
- 4) Adjust each wheel to its axis, place the washer and secure with the pins "R" (Fig. 1d).
- 5) Install then the hubcaps on the wheels (Fig. 1h).
- 6) Fix the cable with the provided clips (fig.1e).
- 7) Assemble the grass catcher: Assemble the two halves and attach them to each other. Install the handle on the top of the grass catcher (fig.1f).
- 8) Lift the flap and place the grass catcher on the legs (fig.1g).

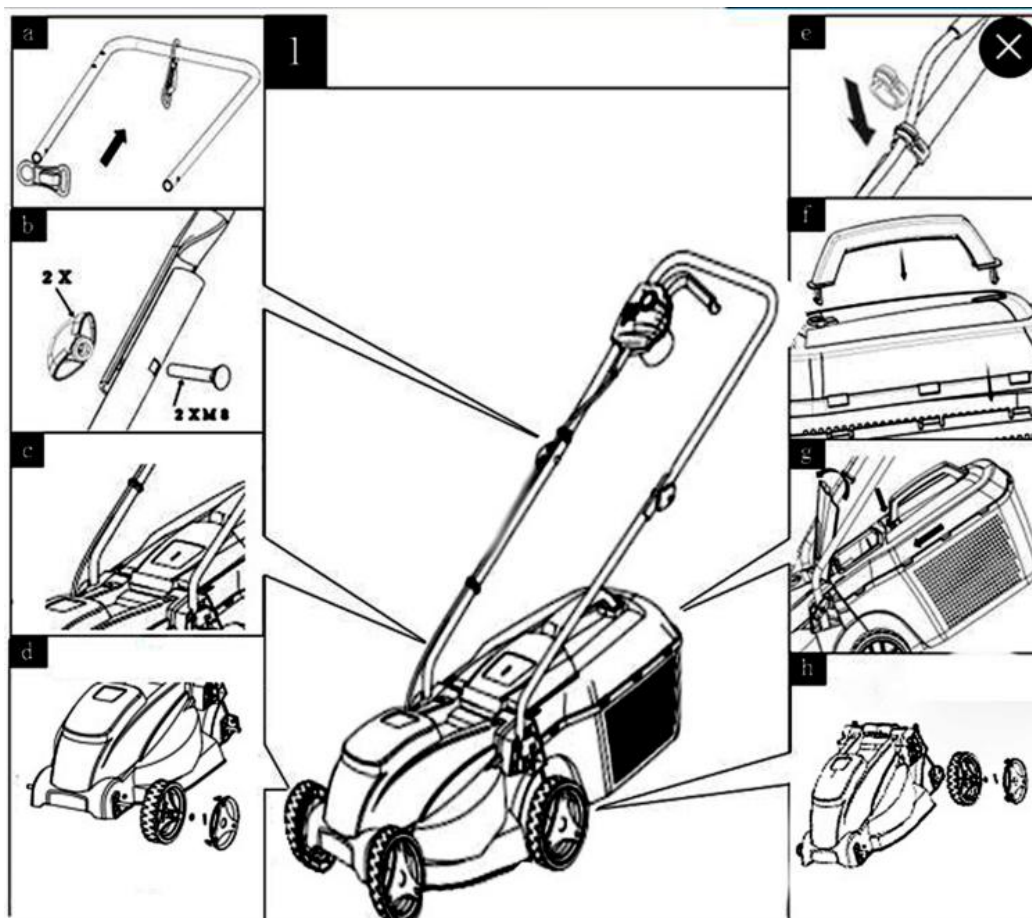

3.2 CUTTING HEIGHT ADJUSTMENT

To obtain the desired cutting height, the front and rear axles are repositioned on the underside of the mower housing. There are 3 heights: low – medium – high.

- 1) 25mm (lowest cutting height position)
- 2) 45mm
- 3) 65mm (highest cutting height position)

Warning! Disconnect the mower from the power supply and ensure the blade has stopped coasting before adjusting the height.

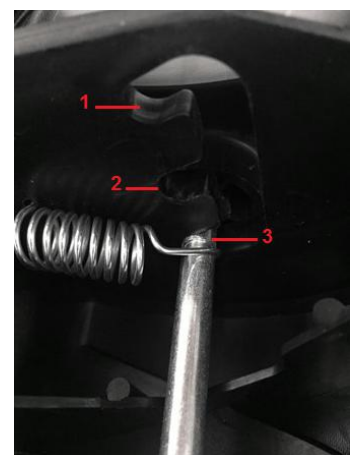

- **To adjust the front wheel cutting height position**

- Turn the mower upside down.
- Pull the wheel axle towards the front of the mower (1).
- Locate the wheel axle into the desired cutting height adjustment position (2).

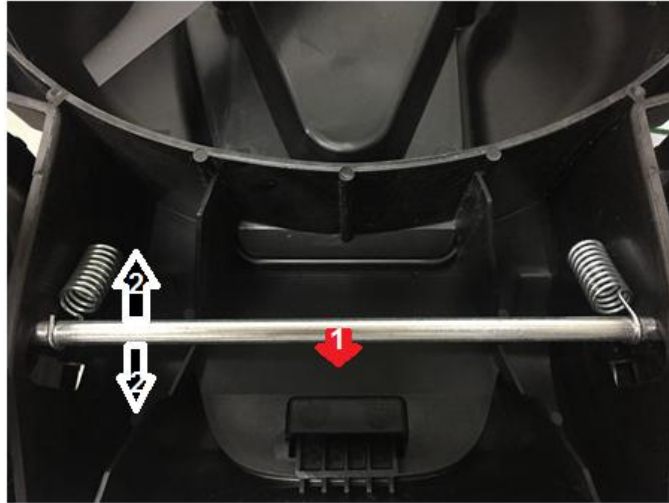

Note: Make sure that both front right and left wheels are located in the same cutting height adjustment position.

- **To adjust the rear wheel cutting height position**

- 1) Turn the mower on its side.
- 2) Pull the rear wheel axle towards the mower's catcher flap (1).
- 3) Locate the wheel axle into the desire cutting height adjustment position (2).

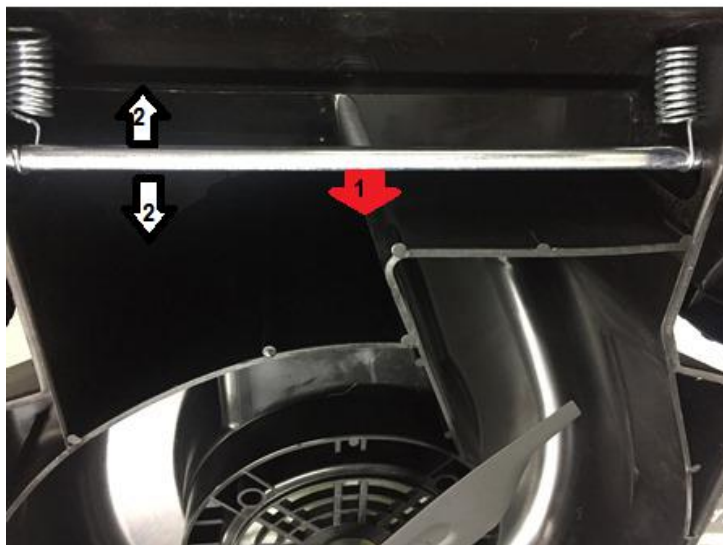

Note: Make sure that both rear right and left wheel are located in the same cutting height adjustment position.

4. OPERATION

4.1 CONNECT TO POWER SUPPLY

Warning! Before connecting to the main power supply, always check that the switch is off.

- Use an extension cord that meets the requirements of this manual.
- Connect this extension to the power socket of the tool.
- Then connect the extension cord to a socket outlet.

4.2 STARTING

Caution! Do not start the mower if it is standing in long grass. Press the safety button (A) of the switch assembly and then pull the switch lever (B) against the bar. Keep the switch lever held whilst releasing the safety button. To stop the mower release the switch lever and it automatically returns to its off position.

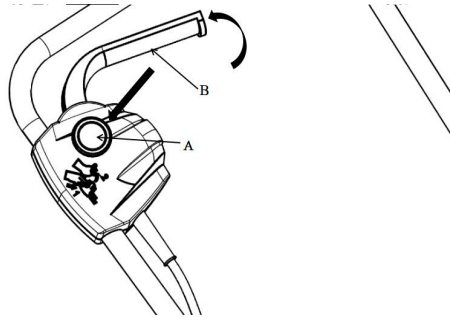

4.3 MOWING

We recommend using your mower as outlined in this section in order to achieve optimum results and to reduce the risk of cutting the mains cable.

- Place the bulk of the mains cable on the close to the starting point.
- Switch the mower on as described above.
- Move from position 1 to position 2
- Turn right and proceed towards position 3
- Turn left and move towards position 4
- Repeat the above procedures as required.

Warning! Do not work towards the cable.

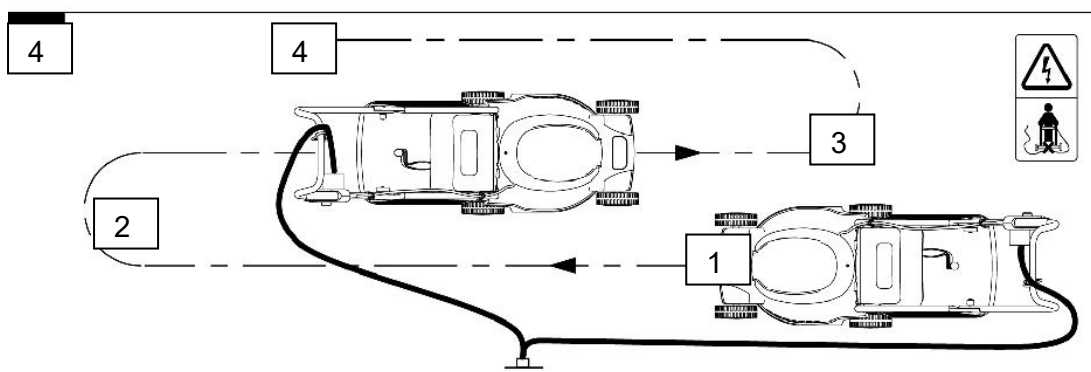

4.4 INSTRUCTIONS FOR THE GRASS CATCHER

- Assembly: Lift the flap and place the grass catcher on the lugs.
- Emptying the grass catcher: Before manipulate on the grass catcher, switch off the engine and wait for the blade to come to a complete stop. Lift the flap and remove the grass catcher.
- When you see grass scattering under the mower, please empty the grass catcher. However, never use the device without the grass catcher.

5. MAINTENANCE

5.1 GENERAL MAINTENANCE

Keep all nuts, bolts and screws tight to be sure the lawn mower is in a safe working condition.

1. Check the grass catcher frequently for wear or deterioration.
2. Replace worn or damaged parts for safety.
3. Only use the replacement blade, blade bolt and impeller specified for this product.
4. Be careful during adjustments of the lawn mower to prevent entrapment of the fingers between moving blade and fixed parts of the machine.
5. Oil the wheel pins.
6. Store the lawn mower in a dry place.

5.2 BLADE MAINTENANCE

- Regularly remove grass and dirt from the blade.
- At the beginning of the gardening season, carefully examine the condition of the blade.
- If the blade is very blunt, sharpen or replace the blade.
- If the blade is damaged or worn, fit a new blade.

If the blade is slipping, put the screwdriver into the location hole, tighten the blade by wrench.

Warning! Observe the following precautions:

- Disconnect the mower from the mains and wait until the blade has stopped rotating before proceeding.
- Be careful not to cut yourself. Use heavy-duty gloves or a cloth to grip the blade.
- Only use the specified replacement blade.

5.3 TO REPLACE THE BLADE

- Unplug the power cord from the mower. Put the mower on its side.
- Grip the blade with one hand.
- Use the spanner (not supplied) to loosen and remove the blade nut.
- Replace the blade
- Securely tighten the blade nut.

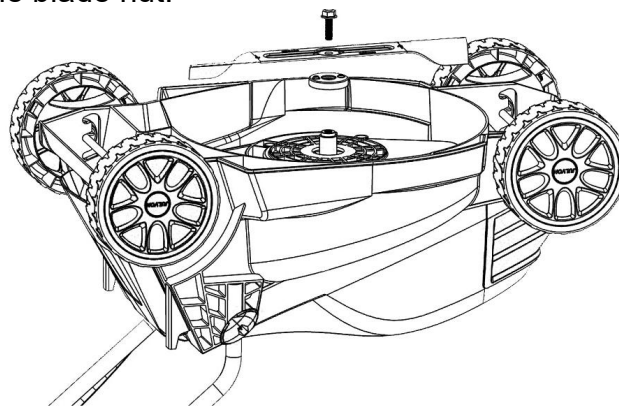

6. DISPOSAL



Electrical products should not be discarded with household products. According to the European Directive 2012/19/EU on waste electrical and electronic equipment and its implementation into national law, electrical products used must be collected separately and disposed of at collection points provided for this purpose. Talk with your local authorities or dealer for advice on recycling.

7. DECLARATION OF CONFORMITY

BUILDER SAS
32, rue Aristide Bergès -Z1 31270 Cugnaux - France
Tel. +33 (0) 5.34.502.502 Fax: +33 (0) 5.34.502.503

Declares that the machine named below
ELECTRIC LAWNMOWER
RAC1030ELA

Serial number: 20210957149-20210957598

Complies with the following European Directives:

Machinery Directive 2006/42/EC

EMC Directive 2014/30/EU

Rohs Directive (EU)2015/863 amending 2011/65/EU

Other applicable Directives:

Noise Directive 2000/14/EC Annex VI and 2005/88/EC

| | |
|------------------------------|----------------------------|
| Guaranteed sound power level | 96 dB(A) |
| Measured sound power level | 90,9 dB (A) K= 3,69 dB (A) |

Notified body

TÜV SÜD Industrie Service GmbH (Notified Body 0036)
Westendstrasse 199 • 80686 München • Deutschland

Applicable harmonized standards:

EN60335-1:2012/A2:2019;

EN60335-2-77:2010;

EN55014-1:2017

EN55014-2:2015

EN61000-3-2:2014

EN61000-3-3:2013

Cugnaux, 06/09/2021

Philippe MARIE / CEO



Responsible of technical file: M. Olivier Patriarca

8. WARRANTY



WARRANTY

The manufacturer guarantees the product against defects in material and workmanship for a period of 2 years from the date of the original purchase. The warranty only applies if the product is for household use. The warranty does not cover breakdowns due to normal wear and tear.

The manufacturer agrees to replace parts identified as defective by the designated distributor. The manufacturer does not accept responsibility for the replacement of the machine, in whole or in part, and/or ensuing damage.

The warranty does not cover breakdowns due to:

- insufficient maintenance.
- abnormal assembly, adjustment or operations of the product.
- parts subject to normal wear and tear.

The warranty does not extend to:

- shipping and packaging costs.
- using the tool for a purpose other than that for which it was designed.
- the use and maintenance of the machine done in a manner not described in the user manual.

Due to our policy of continuous product improvement, we reserve the right to alter or change specifications without notice. Consequently, the product may be different from the information contained therein, but a modification will be undertaken without notice if it is recognized as an improvement of the preceding characteristic.

READ THE MANUAL CAREFULLY BEFORE USING THE MACHINE.

When ordering spare parts, please indicate the part number or code, you can find this in the spare parts list in this manual. Keep the purchase receipt; without it, the warranty is invalid. To help you with your product, we invite you to contact us by phone or via our website:

- **+33 (0)9.70.75.30.30**
- **<https://services.swap-europe.com/contact>**

You must create a "ticket" via the web platform.

- Register or create your account.
- Indicate the reference of the tool.
- Choose the subject of your request.
- Describe your problem.
- Attach these files: invoice or sales receipt, photo of the identification plate (serial number), photo of the part you need (for example: pins on the transformer plug which are broken).



9. PRODUCT FAILURE

WHAT TO DO IF MY MACHINE BREAKS DOWN?

If you bought your product in a store:

- a) Empty the fuel tank if your product has one.
- b) Make sure that your machine is complete with all accessories supplied, and clean! If this is not the case, the repairer will refuse the machine.

Go to the store with the complete machine and with the receipt or invoice.

If you bought your product on a website:

- a) Empty the fuel tank if your product has one.
- b) Make sure that your machine is complete with all accessories supplied, and clean! If this is not the case, the repairer will refuse the machine.
- c) Create a SWAP-Europe service ticket on the site: <https://services.swap-europe.com> When making the request on SWAP-Europe, you must attach the invoice and the photo of the nameplate (serial number).
- d) Contact the repair station to make sure it is available before dropping off the machine.

Go to the repair station with the complete machine packed, accompanied by the purchase invoice and the station support sheet downloadable after the service request is completed on the SWAP-Europe site

For machines with engine failure from manufacturers BRIGGS & STRATTON, HONDA and RATO, please refer to the following instructions.

Repairs will be done by approved engine manufacturers of these manufacturers, see their site:

- <http://www.briggsandstratton.com/eu/fr>
- <http://www.honda-engines-eu.com/fr/service-network-page;jsessionid=5EE8456CF39CD572AA2AEEDFD290CDAE>
- <https://www.rato-europe.com/it/service-network>

Please keep your original packaging to allow for after-sales service returns or pack your machine with a similar cardboard box of the same dimensions.

For any question concerning our after-sales service you can make a request on our website <https://services.swap-europe.com>

Our hotline remains available at +33 (9) 70 75 30 30.



10. WARRANTY EXCLUSIONS

THE WARRANTY DOES NOT COVER:

- Start-up and setting up of the product.
- Damage resulting from normal wear and tear of the product.
- Damage resulting from improper use of the product.
- Damage resulting from assembly or start-up not in accordance with the user manual.
- Breakdowns related to carburetion beyond 90 days and fouling of carburetors.
- Periodic and standard maintenance events.
- Actions of modification and dismantling that directly void the warranty.
- Products whose original authentication marking (brand, serial number) has been degraded, altered or withdrawn.
- Replacement of consumables.
- The use of non-original parts.
- Breakage of parts following impacts or projections.
- Accessories breakdowns.
- Defects and their consequences linked to any external cause.
- Loss of components and loss due to insufficient screwing.
- Cutting components and any damage related to the loosening of parts.
- Overload or overheating.
- Poor power supply quality: faulty voltage, voltage error, etc.
- Damages resulting from the deprivation of enjoyment of the product during the time necessary for repairs and more generally the costs related to the immobilization of the product.
- The costs of a second opinion established by a third party following an estimate by a SWAP-Europe repair station
- The use of a product which would show a defect or a breakage which was not the subject of an immediate report and/or repair with the services of SWAP-Europe.
- Deterioration linked to transport and storage*.
- Launchers beyond 90 days.
- Oil, petrol, grease.
- Damages related to the use of non-compliant fuels or lubricants.

* In accordance with transport legislation, damage related to transport must be declared to carriers within 48 hours maximum after observation by registered letter with acknowledgement of receipt.

This document is a supplement to your notice, a non-exhaustive list.

Attention: all orders must be checked in the presence of the delivery person. In case of refusal by the delivery person, it you must simply refuse the delivery and notify your refusal.

Reminder: the reserves do not exclude the notification by registered letter with acknowledgement within 72 hours.

Information: Thermal devices must be wintered each season (service available on the SWAP-Europe site). Batteries must be charged before being stored.



BUILDER SAS
32, rue Aristide Bergès - ZI 31270 Cugnaux – France
Made in PRC 2021